



Technical Service BULLETIN

November 11, 2005

Title:

FRONT EMERGENCY TOWING EYELETS & EYELET HOLE COVERS

Models:

'06 RAV4

PD078-05

PRE-DELIVERY SERVICE

Introduction The 2006 model year RAV4 is shipped with two front emergency towing eyelets. Follow the procedure below to remove the eyelets and save one for customer use.

Applicable Vehicles

- 2006 model year **RAV4** vehicles.

Warranty Information

OP CODE	DESCRIPTION	TIME	OFP	T1	T2
N/A	Not Applicable to Warranty	—	—	—	—

Removal & Installation Procedure

1. Remove the two emergency towing eyelets from the front bumper by turning them counterclockwise.

NOTE:

If it is difficult to loosen the eyelets, use a steel bar.

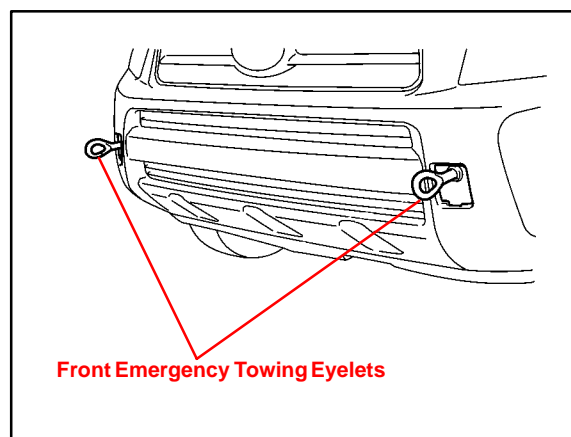

Removal & Installation Procedure
(Continued)

2. Place one of the emergency towing eyelets into the tool bag located in the luggage compartment.

NOTE:

Dispose of the other eyelet.

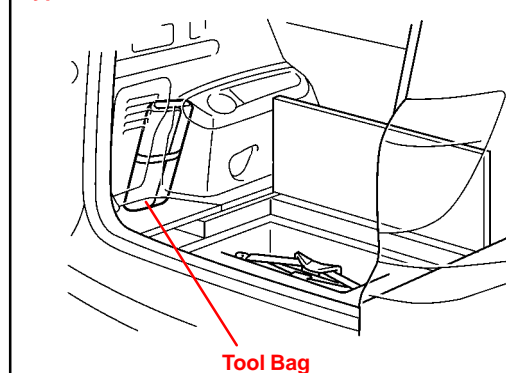
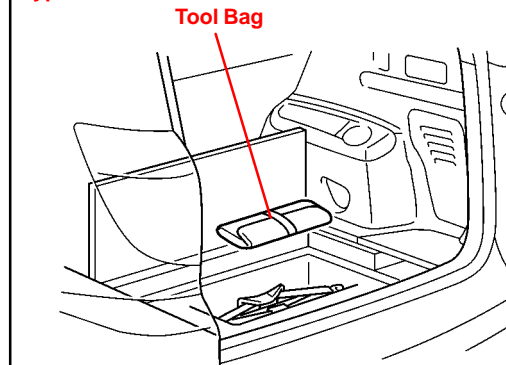
Type A**Type B**

3. Install the two front emergency towing eyelet hole covers, which are stored in the glove box, onto the front bumper.
Insert the arrow-shaped part (A) of the eyelet hole cover into the hole (B) as shown in the illustration.

